

PIPE-CLEANING MOTORS

• PNEUMATIC

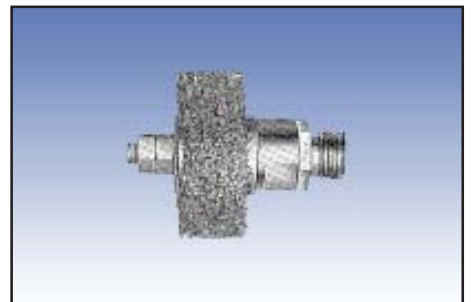
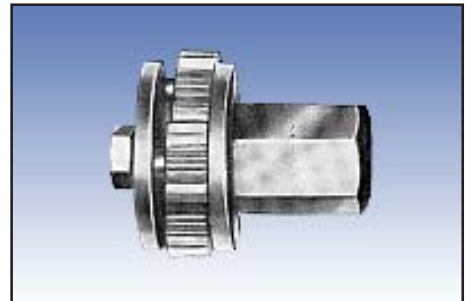
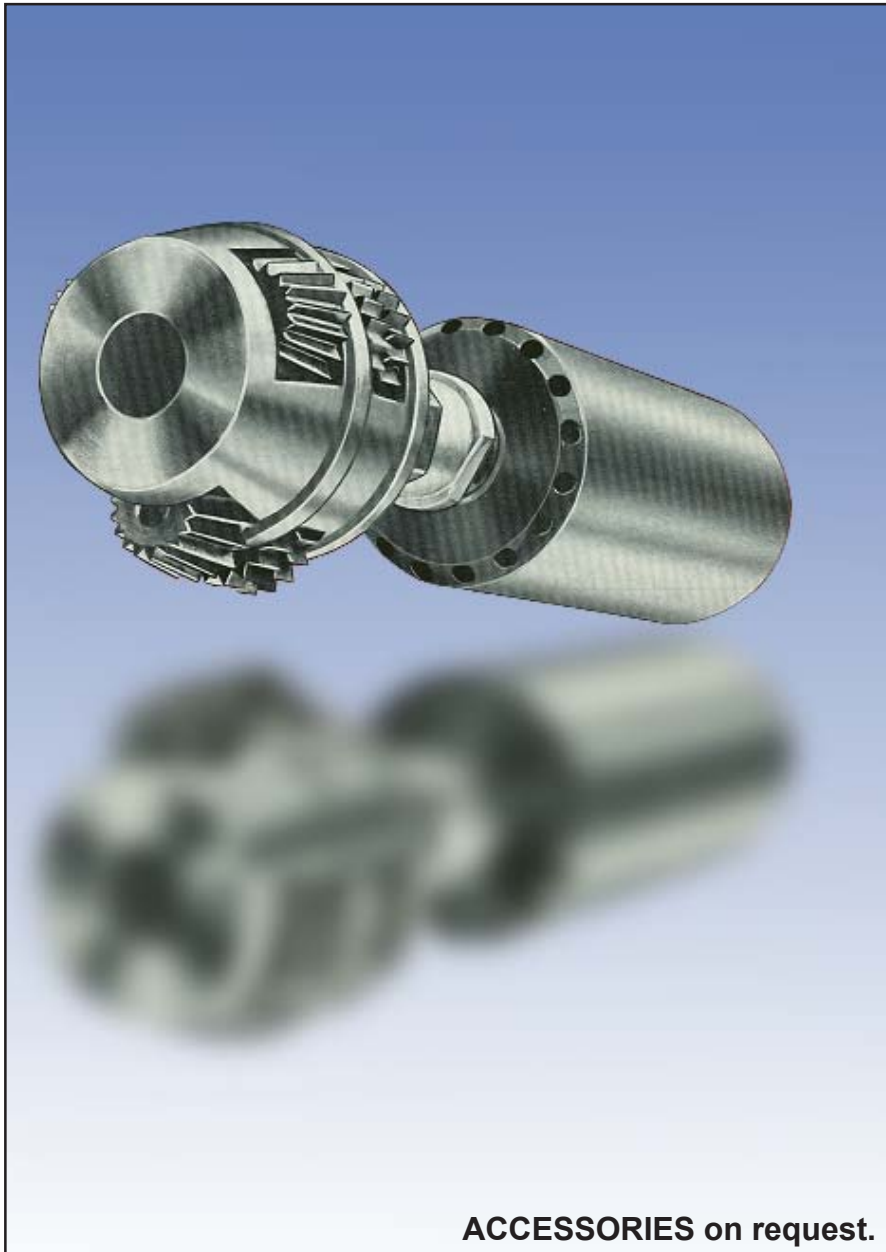

TECHNICAL SPECIFICATIONS (Subject to technical change)

Part Number	for pipes ID	Minimum radius of pipe bend	Motor body dia.	Spindle connecting thread	Power	Free speed	Air consumption	Air connection	Weight
	mm	mm	mm		kW	rpm	m ³ /min	m/s ²	kgs
4 1101 0010	24 - 32	500	22	5/16"	0,37	11000	0,8	R 1/4"	0,21
4 1201 0010	32 - 40	500	30	3/8 "	0,44	8500	0,8	R 3/8"	0,46
4 1401 0010	40 - 50	500	37	7/16 "	0,60	5000	0,8	R 1/2"	0,55
4 1505 0010	46 - 65	700	42	1/2 "	0,70	8000	1,2	R 3/4"	1,8
4 1702 0010	72 - 85	800	68	3/4 "	0,90	7000	1,3	R 3/4"	4,2
4 1801 0010	85 - 100	-	80	7/8 "	1,85	6400	2,65	R 1"	6,5
4 1901 0010	100 - 120	-	96	1 1/4 "	2,20	5000	3,1	R 1"	10,0

Performance data at an operating pressure / flow pressure of 6 bar